

WLtoys 124010 RC Cars 1:12 Scale RC Car 4WD 55KM/H High Speed RC Racing Car 2.4GHz All Terrains Off Road RC Buggy

Specifications

- Item Name: Remote Control Car
 - Model: 124010
 - Scale: 1:12
 - Main Material: Alloy, PA
 - Maximum Speed: 55km/h
 - Frequency: 2.4GHz
 - Motor: 560 Strong Magnetic Carbon Brush Motor
 - Charging Time: About 3h
 - Working Time: About 8min
 - Remote Control Distance: About 100 Meters
 - Car Battery: 7.4V 1300mAh Battery(Included)
 - Remote Controller Battery: 4*AAA Battery(not Included)
 - Size: 34.7*21.1*12.2cm/13.6*8.3*4.8inch
-
- Package List:
 - 1* Remote Control Car,
 - 1* Remote Controller,
 - 1* Car Battery,
 - 1* Charging Cable,
 - 1* Cross Wrench,
 - 1* Screwdriver,
 - 1* User Manual

NO. 124010

ELECTRIC **1:12** 4WD RACING CAR

55KM/H High Speed
Remote Control Car



OUTPUT DRIVING FORCESTRONG

To achieve high speed, rapid acceleration, deceleration, braking speed up to 55 Km/h.
This may be your favorite equipment, is about to take you on a speed trip.

Speed Racing



Metal Oil Pressure Shock Absorbers

- Using simulated metal oil pressure shock absorbers, can effectively reduce the vibration when the remote control car driving, so that the smooth running.

One Hand Control

- The new remote controller add a lever to the steering wheel, then you can realize the function of one hand operation, make it easier to control.

Integrated Mobile Phone Holder

- In order to facilitate the external camera to achieve real-time control vision, the remote controller is equipped with a built-in mobile phone bracket for smooth play.

PVC Color Printing Shell

- The body adopts anti-explosion PVC color printed car shell, with anti-collision and anti-fall function, adapt to a variety of terrains.



560 Strong Magnetic Motor

- Using 560 strong magnetic carbon brush motor, fast speed, high efficiency, high-quality motor to make the horsepower more powerful, up to 55Km/h.

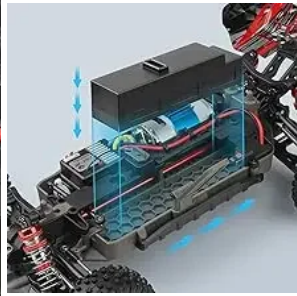

Rechargeable Lithium Battery

- Efficient discharge rate battery, 7.4V 1300mAh lithium battery provides coreless motor with powerful force, working time about 8 minutes.

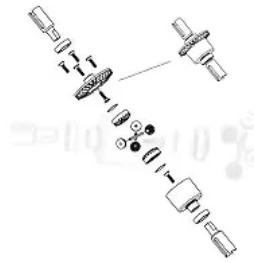

Zinc Alloy Gear

- Adopt the zinc alloy gear, it is more higher strength and wear resistance than the general plastic gear, can improve the service life of the gear.



Rubber Tire

- Made of rubber material, soft and elastic. Concave and convex tire texture increases friction, and enhance the grip of the rc car tire grain deep.

2.4GHZ REMOTE CONTROL MODE

100m
CONTROL DISTANCE



2.4GHz has great advantages, even there are other people in the operation of car in the same space, the frequency will not be interfered with the same frequency.

Product Description

Product Information

NO.124010

Name.
1:12 Electric 4WD Racing Car

Size.
34.7×21.1×12.2cm

Box size.
33.7×23.3×16.5cm

Mode.
2.4GHz (Control Distance is about 100m)

Motor.
560 Strong Magnetic Carbon Brush Motor

Battery.
7.4V 1300mAh *1



